

RM SERIES

RM3117

3 TWIN CHANGE-OVER CONTACTS, 11 PINS, TPDT.

TYPE

RM3117 ... V
Industrial Relay for low level applications
3 CO

MAX. CONTACT LOAD

6 A / 250 V AC1 6 A / 30 V DC1

CONTACT

Material Standard AgNi + 0,2 μ Au
Optional AgNi + 10 μ Au

Rated current / Max. peak current 6 A / 15 A
Rated voltage / Max. switching voltage AC-1 250 V / 400 V
Rated load AC15 (250 V) 350 VA
Min. switching load 5 V / 5 mA
5 V / 1 mA (10 μ Au)

COIL

Operation range $\leq 0,8 \times U_N - 1,1 \times U_N$
Rated power (AC/DC) 2,2 VA / 1,3 W
Release voltage $\geq 0,1 \times U_N$
Coil resistance $\pm 10\%$

Coil data

VAC	Ω	mA	VDC	Ω	mA
24	67	92	24	433	54
48	296	46	48	1K8	27
115	1K7	19	110	9K2	12
230	7K1	9,5	220	36K1	6

INSULATION (Vrms, 1 min)

Contact open 1 KV
Coil /Contacts 2,5 KV
Insulation IEC 61810-1 2,5 KV / 3
Between contacts 2,5 KV

SPECIFICATIONS

Ambient temperature - 40 °C ... + 80 °C
Operation / Release time 16 ms / 8 ms
Protection category IP40
Electrical life DC / Mechanical life 1·10⁵ op / 10·10⁶ op (AC) 20·10⁶ op (DC)
Weight 90 g

ACCESSORIES

Sockets SMB30D, SMT30D, SMB30P, SMB30S, SMW30F, SMP30F

ORDERING CODE

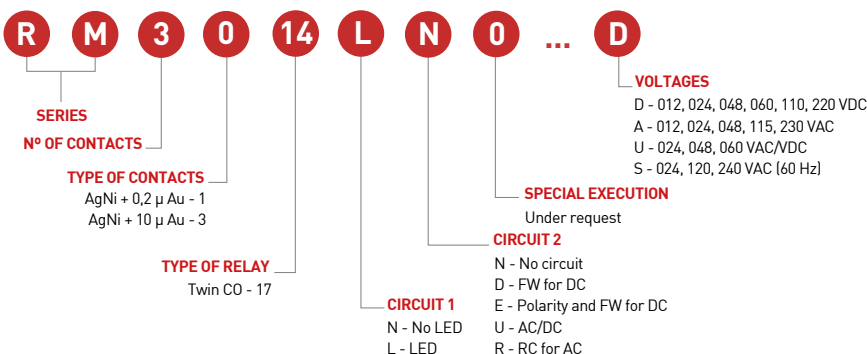

CONNECTION DIAGRAM

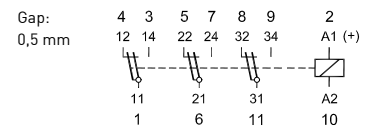

FIG. 1 ELECTRICAL LIFE AC LOAD

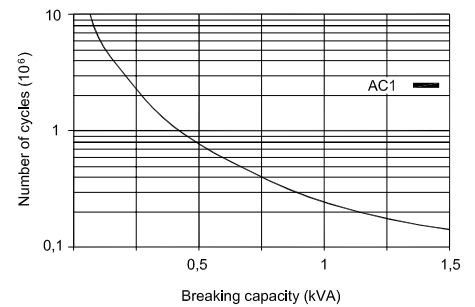
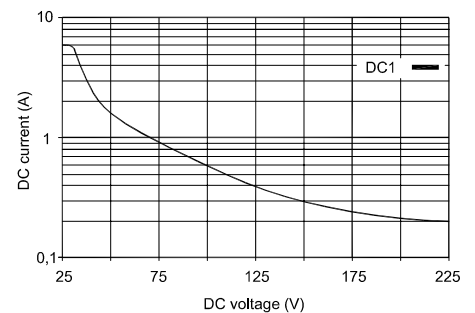
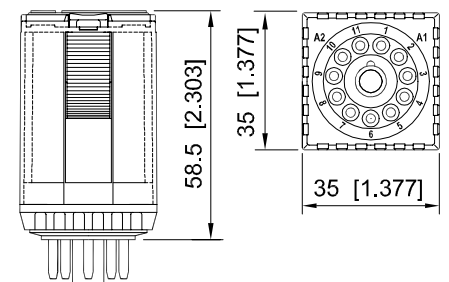

FIG. 2 MAX. DC BREAKING CAPACITY



DIMENSIONS mm [inch]



TECHNICAL APPROVALS



In process In process In process In process
IEC 61810; EN 60947