

# RM SERIES

## RM1015

1 DOUBLE MAKE OPEN CONTACT, 11 PINS, SPST.

### TYPE

RM1015 ... V  
Industrial Relay for DC applications  
1 NO double make

### MAX. CONTACT LOAD

10 A / 250 V AC1 7 A / 110 V DC1  
10 A / 30 V DC1 1,2 A / 220 V DC1

### CONTACT

Material Standard AgNi

Rated current / Max. peak current 10 A / 30 A  
Rated voltage / Max. switching voltage AC-1 250 V / 400 V  
Rated load AC15 (250 V) 750 VA  
Min. switching load 10 V / 10 mA

### COIL

Operation range  $\leq 0,8 \times U_N - 1,1 \times U_N$   
Rated power (AC/DC) 2,4 VA / 1,3 W  
Release voltage  $\geq 0,1 \times U_N$   
Coil resistance  $\pm 10\%$

Coil data

VAC	$\Omega$	mA	VDC	$\Omega$	mA
24	65	100	24	443	54
48	286	50	48	1K7	27
115	1K7	21	110	9K2	12
230	6K8	10	220	36K1	6

### INSULATION (Vrms, 1 min)

Contact open 2,5 KV  
Coil /Contacts 2,5 KV  
Insulation IEC 61810-1 2,5 KV / 3  
Between contacts

### SPECIFICATIONS

Ambient temperature - 40 °C ... + 80 °C  
Operation / Release time 20 ms / 10 ms  
Protection category IP40  
Electrical life DC / Mechanical life 1·10<sup>5</sup> op / 10·10<sup>6</sup> op (AC) 20·10<sup>6</sup> op (DC)  
Weight 90 g

### ACCESSORIES

Sockets SMB30D, SMB30P, SMB30S, SMW30F, SMP30F, SMT30D

### ORDERING CODE

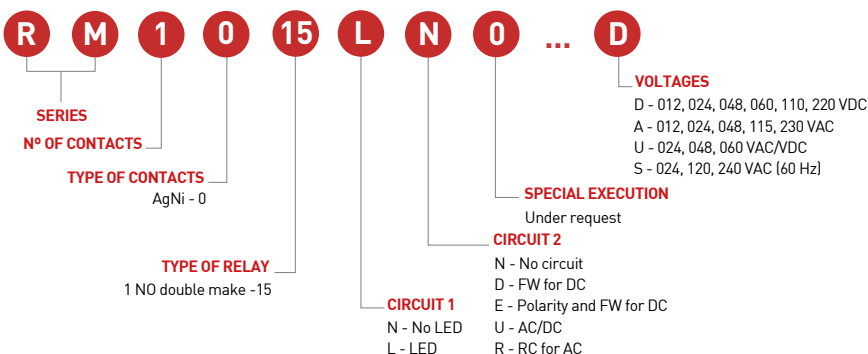

### CONNECTION DIAGRAM

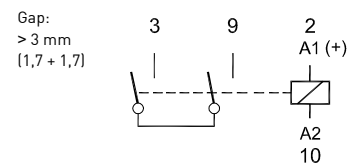

FIG. 1 ELECTRICAL LIFE AC LOAD

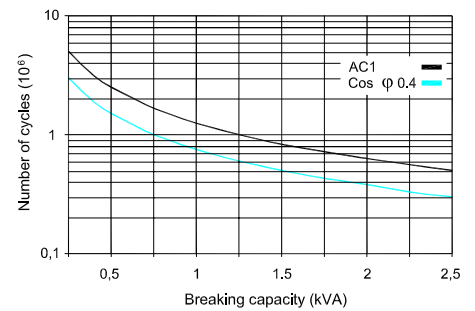
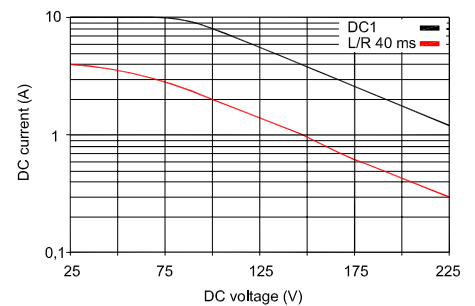
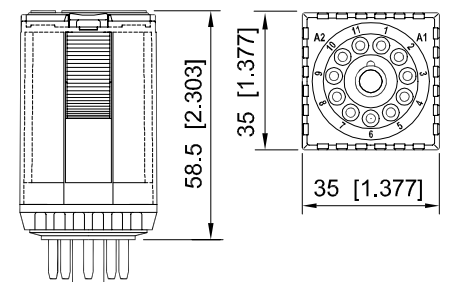

FIG. 2 MAX. DC BREAKING CAPACITY



### DIMENSIONS mm [inch]



### TECHNICAL APPROVALS



IEC 61810; EN 60947