

RM SERIES

RM3113

3 CHANGE-OVER CONTACT SENSITIVE RELAY, 11 PINS, TPDT.

TYPE

RM3113 ... V
Sensitive Industrial Relay (800 mW)
3 CO

MAX. CONTACT LOAD

6 A / 30 V AC1 6 A / 30 V DC1

CONTACT

Material Standard AgNi + 0,2 μ Au
Optional AgNi + 10 μ Au

Rated current / Max. peak current 6 A / 15 A
Rated voltage / Max. switching voltage AC-1 250 V / 400 V
Rated load AC15 (250 V) 350 VA
Min. switching load 10 V / 5 mA
5 V / 5 mA (10 μ Au)

COIL

Operation range $\leq 0,8 \times U_N - 1,4 \times U_N$
Rated power (DC) 800 mW
Release voltage $\geq 0,1 \times U_N$
Coil resistance $\pm 10\%$

Coil data

VDC	Ω	mA
24	720	33
48	2K8	17
60	4K5	13
110	15K	7

INSULATION (Vrms, 1 min)

Contact open 1 KV
Coil / Contacts 2,5 KV
Insulation IEC 61810-1 2,5 KV / 3
Between contacts 2,5 KV

SPECIFICATIONS

Ambient temperature - 40 $^{\circ}$ C ... + 80 $^{\circ}$ C
Operation / Release time 18 ms / 10 ms
Protection category IP40
Electrical life DC / Mechanical life 1 \cdot 10⁵ op / 10 \cdot 10⁶ op (AC) 20 \cdot 10⁶ op (DC)
Weight 90 g

ACCESSORIES

Sockets SMB30D, SMT30D, SMB30P, SMB30S, SMW30F, SMP30F

ORDERING CODE

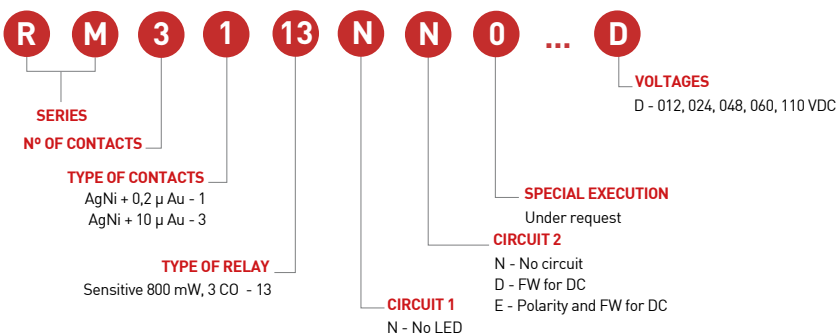

CONNECTION DIAGRAM

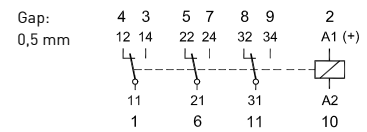

FIG. 1 ELECTRICAL LIFE AC LOAD

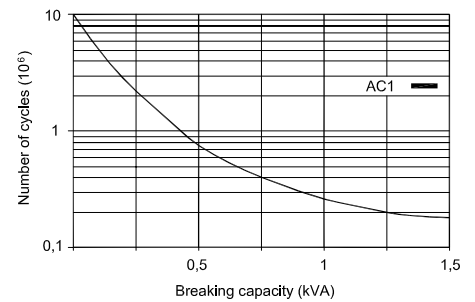
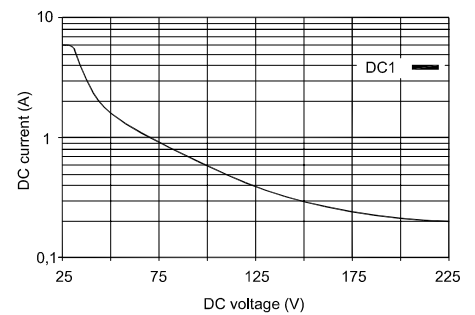
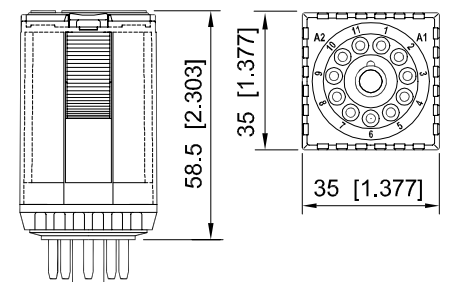

FIG. 2 MAX. DC BREAKING CAPACITY



DIMENSIONS mm [inch]



TECHNICAL APPROVALS



IEC 61810; EN 60947